



**MONUMENT
NATIONAL**

Le Café

TECHNICAL RIDER 2020-21

GENERAL INFORMATION

Address	1182, boulevard Saint-Laurent Montréal, QC H2X 2S5
Telephone	(514) 871-9883
Email	info@monumentnational.com
Rentals & Partnerships	Guillaume Fontaine location@monumentnational.com (514) 871-9883, ext. 227
Technical Direction	directiontechniquemn@ent-nts.ca 514.871.9883, ext. 236
Maximum capacity	180 (cocktail)
Production Office	None
Control Booth	None
Dressing room	Located in the lobby hall, facing the side of the main stair case
Security	Technical personnel must wear steel-toed footwear. Wearing a safety helmet is mandatory when working at a height. A safety harnesses is mandatory for anyone working at a height greater than 10' measured from the floor.

VENUE

Located on the ground floor of the Monument-National, **Le Café** has floor-to-ceiling windows that look out onto Saint-Laurent Boulevard, symbolizing its openness to Montreal's city life. It is equipped with versatile technical equipment, making it ideal for a wide range of activities – launches, conferences, intimate gatherings, shows – all in a warm, inviting atmosphere. This venue can accommodate 100 people seated or 180 in a cocktail setting.

FURNISHINGS

FURNITURE

1	Lectern
4	Square café tables (30" by 30" and 28" high)
6	round cabaret tables (20" in diameter and 28" high)
7	round cabaret tables (24" in diameter and 45" high)
39	chairs
35	barstools 38"
7	3' x 6' risers that can be used to make a small stage (9'X15') includes sets of legs, 8" and 16"

CURTAIN

1	set of blackout curtains for the widows facing Saint-Laurent Boulevard
---	--

NOTE: Basic facilities are available onsite for caterers

LIGHTING EQUIPMENT

20	Strand CPD1 Dimmers 3.6kW
24	Strand CD80 Dimmers
1	Strand 200S Console 24 controls
1	grid at 14' 6"
10	Leko 1kW Strand Century 6 x 9
10	Leko 1kW Strand Century 6 x 12
8	Lumi PARs 575W – VN / N / Med / Wide

NOTE: The ambient lighting is permanently installed and cannot be reconfigured. All other lighting equipment needs to be set up and taken down after each event.

SOUND EQUIPMENT

1	Yamaha Mixing Console MG16 – 16 Line Inputs, 4 AUX
4	Yamaha MSR 400 Powered Speakers
2	Yamaha MSR 400 Powered Speakers (movable)
2	Yamaha MSR 800W Powered Subwoofer
1	Yamaha SP 2060 Speaker Processor
1	Denon DN-C630 CD player
1	Shure SM-58 microphones
2	Mono Passive DI units
1	distribution box for the press

PROJECTION EQUIPMENT

1	Sharp projector 4500 Lumens
1	Projection screen 16' x 9'



Plan et coupe
Spectacle:

Page
1/6

Révision
Août 2020

Échelle
3/32"=1'

Monument-National
Café

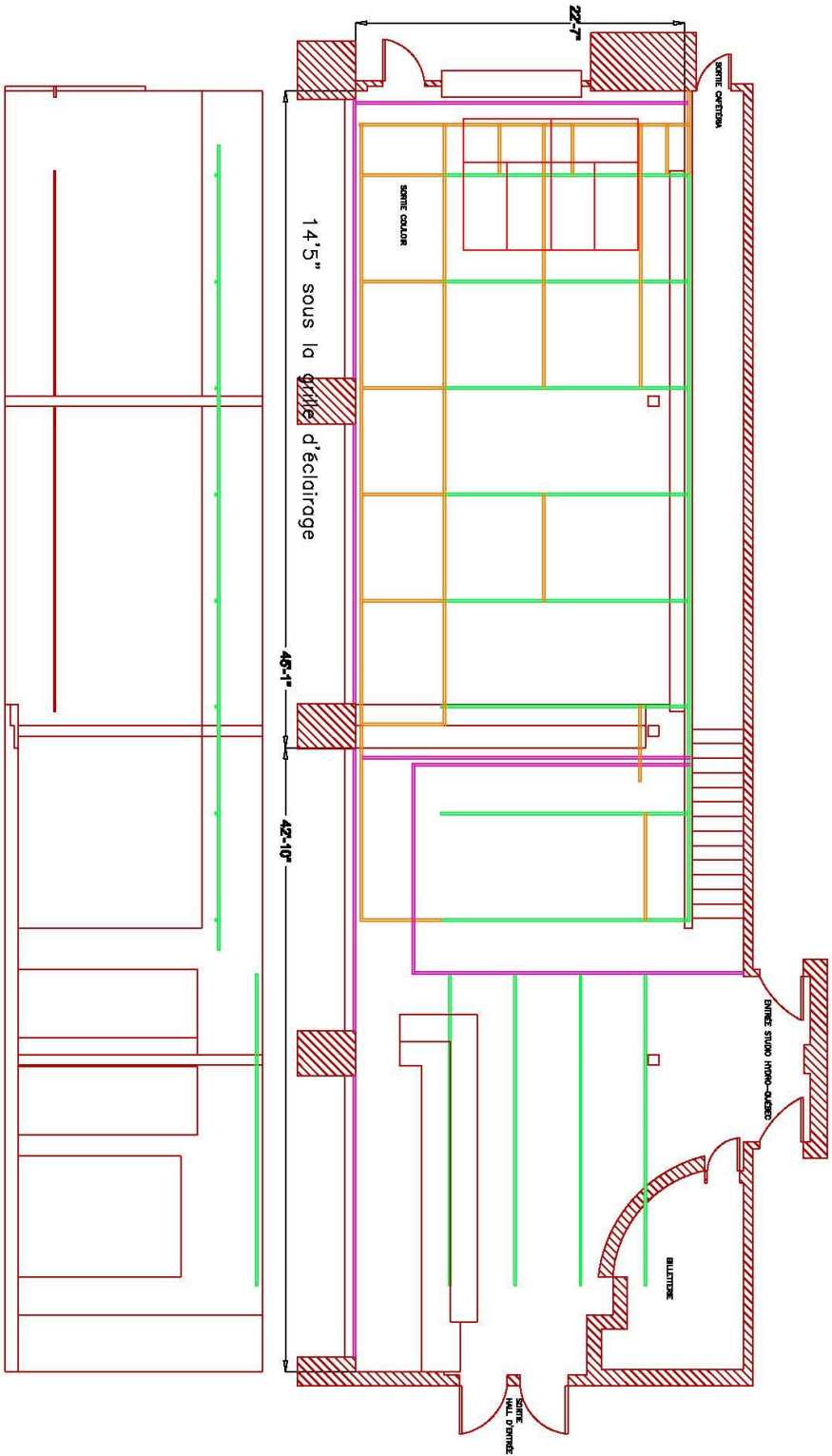

The Monument-National forms one of two campuses of the National Theatre School of Canada.

- Located near the corner of Saint-Laurent and René-Lévesque Boulevards, it is within walking distance of both the Saint-Laurent and Place-d'Armes metro stations.
- The main entrance and Box Office are located at 1182 Saint-Laurent Boulevard; The reception staff and backstage entrance is located at 1170 Saint-Laurent Boulevard.
- It was built in 1893 and entirely renovated in 1993 for its centennial anniversary.
- The Box Office is managed by the Monument-National and powered by Tuxedo (monumentnational.tuxedobillet.com).